



JKK MUNIRAJAH INSTITUTE OF HEALTH SCIENCES COLLEGE OF PHARMACY

(Approved by Tamil Nadu Govt. & Pharmacy Council of India - New Delhi, Affiliated to The Tamil Nadu Dr. M.G.R Medical University, Chennai)
Thookanaickenpalayam, Gobichettipalayam (TK), Erode (DT) - 638506, Tamil Nadu.

3. WATER CONSERVATION FACILITIES AVAILABLE IN THE INSTITUTION

1. Rainwater harvesting
2. Borewell/open well recharge
3. Construction of tank sand bunds
4. Wastewaterrecycling
5. Maintenance of water bodies and distribution system in the campus

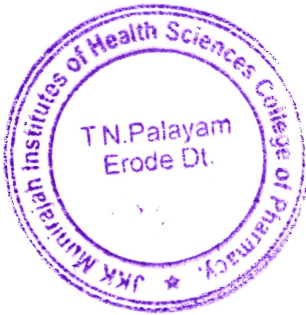

Principal

JKK Munirajah Institute of Health Sciences
College of Pharmacy, T.N.Palayam,
Gobi (Tk), Erode (Dt) - 638 506



JKK MUNIRAJAH INSTITUTE OF HEALTH SCIENCES COLLEGE OF PHARMACY

(Approved by Tamil Nadu Govt. & Pharmacy Council of India - New Delhi, Affiliated to The Tamil Nadu Dr. M.G.R Medical University, Chennai)
Thookanaickenpalayam, Gobichettipalayam (TK), Erode (DT) - 638506, Tamil Nadu.

1. BRIEF REPORT ON RAIN WATER HARVESTING

Rain water harvesting structures and utilization in the campus

Rainwater Harvesting is one of the most commonly used methods to save water. It refers to storing of rainwater for various uses. The Motion behind rainwater harvesting is to not waste the rain water and prevent it from running off. In other words, it is done to collect rainwater using simple mechanisms. This method is very useful considering the water scarcity that is happening in India. Moreover, rainwater harvesting is so easy that almost anyone can do it. We must encourage this practice to help people get access to clean water easily without any cost.

The catchments and settlement tanks reduce the ground heat and act as a natural cooler. The best part of the practice of rainwater harvesting, is that if unused, this water can be collected in natural pond so artificial tank sand decanted to the ground thus charging the a aquifer.

A Rainwater harvesting system comprises of components for – transporting rainwater through pipes or drains, filtration, and tanks for storage of harvested water.

CONCLUSION: Recharge of ground water table is a gradual process, we cannot suddenly increase the ground water table after constructing recharge structures, by constructing any type of recharge structure, and we can give our contribution in aquifer recharge. This will help to rejuvenate the depleting ground water resources. Also help to save the little amount of rain water which used to drain away from many years. Thus, it is concluded that implementation of RWH system JKK Munirajah Institute of Health Sciences College of Pharmacy, T.N. PALAYAM Campus would result in the form of the best approach to deal with present scenario of water scarcity and storing huge quantity in a year in college campus.

Principal

JKK Munirajah Institute of Health Sciences
College of Pharmacy, T.N.Palayam,
Gobi (Tk), Erode (Dt) - 638 506



JKK MUNIRAJAH INSTITUTE OF HEALTH SCIENCES COLLEGE OF PHARMACY

(Approved by Tamil Nadu Govt. & Pharmacy Council of India - New Delhi, Affiliated to The Tamil Nadu Dr. M.G.R Medical University, Chennai)
Thookanaickenpalayam, Gobichettipalayam (TK), Erode (DT) - 638506, Tamil Nadu.

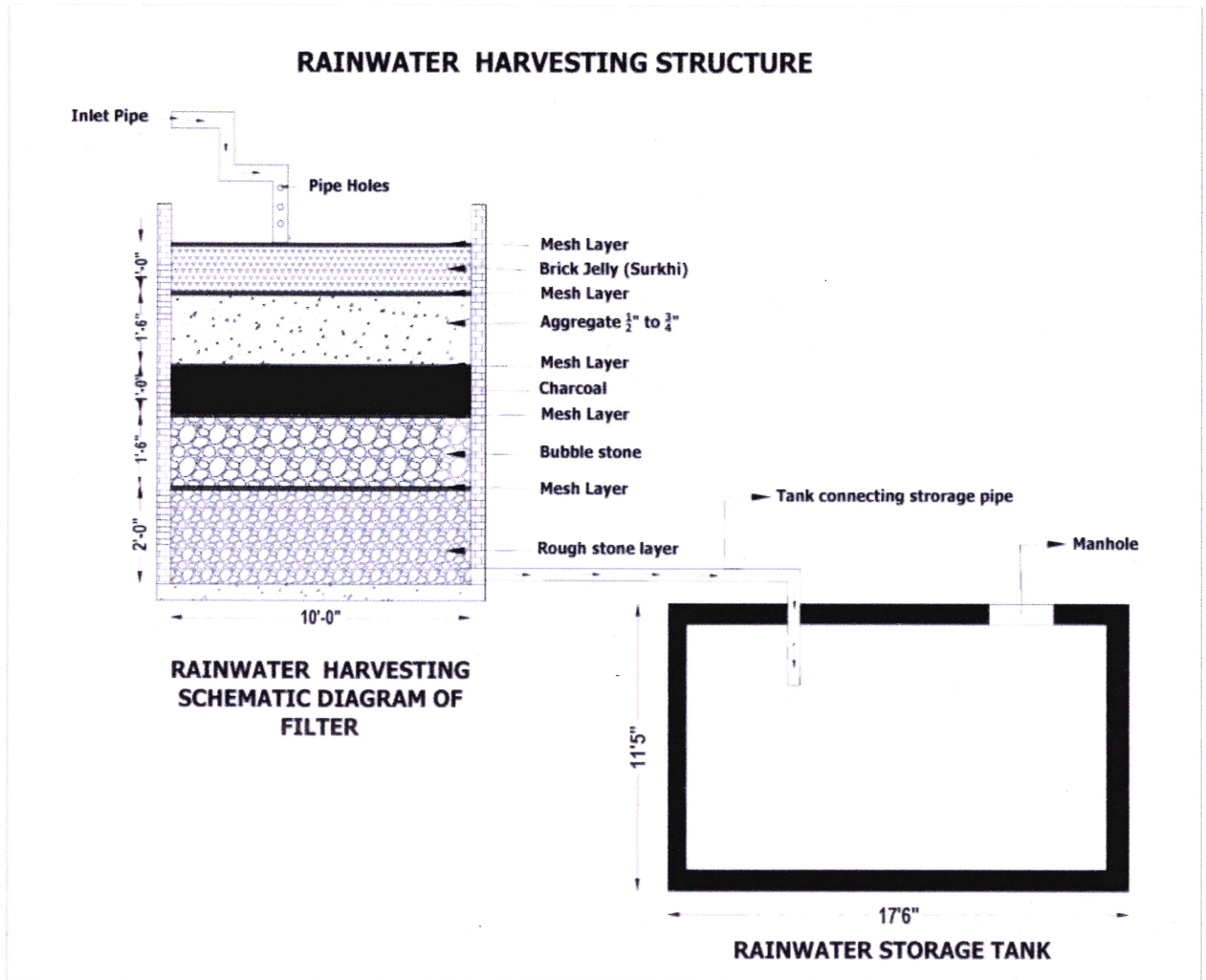

Principal

JKK Munirajah Institute of Health Sciences
College of Pharmacy, T.N.Palayam,
Gobi (Tk), Erode (Dt) - 638 506



JKK MUNIRAJAH INSTITUTE OF HEALTH SCIENCES COLLEGE OF PHARMACY

(Approved by Tamil Nadu Govt. & Pharmacy Council of India - New Delhi, Affiliated to The Tamil Nadu Dr. M.G.R Medical University, Chennai)
Thookanaickenpalayam, Gobichettipalayam (TK), Erode (DT) - 638506, Tamil Nadu.

2. BRIEF REPORT ON BORE WELL

A deep, narrow well for water that is drilled into the ground and has a pipe fitted as a casing in the upper part of the borehole, typically equipped with a pump to draw the water to the surface our College. Easy access and usage of groundwater. The level of contamination in low as the water is below ground and can be accessed via bore well pipes only. Fewer chances of accidents and there is no open ground (Hole). Less dependency on government supply of water. Bore ell is a long-term solution to water accessibility. Bore well is an economical alternative as it will reduce your water bill and will ensure a consistent supply of water.

S.NO	BORE WELL LOCATION	TANKCAPA CITY (In Liters)
1	JKKMIHSCP MAIN BLOCK	15,000
2	SRI SARADHA DEVI ILLAM GIRLS HOSTEL	15,000
3	SRI VIVEKANANDHAR ILLAM BOYS HOSTEL	60,000

Principal

JKK Munirajah Institute of Health Sciences
College of Pharmacy, T.N.Palayam,
Gobi (Tk), Erode (Dt) - 638 506



JKK MUNIRAJAH INSTITUTE OF HEALTH SCIENCES COLLEGE OF PHARMACY

(Approved by Tamil Nadu Govt. & Pharmacy Council of India - New Delhi, Affiliated to The Tamil Nadu Dr. M.G.R Medical University, Chennai)
Thookanaickenpalayam, Gobichettipalayam (TK), Erode (DT) - 638506, Tamil Nadu.

3. BRIEF REPORT ON CONSTRUCTION OF TANKS AND BUNDS

In the college campus tanks are constructed in all areas. The storage tanks situated at various locations of the college are pumped with ground water. We have a separate tank system for drinking as well as bore water for the convenient usage. Water from the bore well, open well and other water bodies are collected through the pipes and stored in the tank (at every block). Maintenance department of the college taking responsible for cleaning the tanks regularly as per the Government norms.

The proper Bunds are constructed in the campus and used for retaining the water, creating obstruction and thus to control erosion. Bunds can be used to hold rainwater in lightly sloping plains and to ensure that bunds continue to provide the necessary protection against leaks and spills etc.

Hence bunds should be assessed periodically to ensure that they continue to provide sufficient integrity around the campus.

CONSTRUCTION OF TANK & BUNDS

It is containment around an area where hazardous liquids are handled, processed or stored. The type of bund most often seen consists of four walls and a base surrounding tank. It prevents leaked material from flowing directly into the process areas.

BRIEF REPORT ON MAINTENANCE OF WATERBODIES AND DISTRIBUTION SYSTEM IN THE CAMPUS

The maintenance of our institutions water bodies is essential. It helps to preserve the biological balance of the Environment. The water bodies are natural assets, having multiple uses such as maintaining the water quality, balancing different environmental conditions.

Water distribution system for a network of pipes, generally in a tree-like structure, that is used to convey water from water bodies to water supplies.

DISTRIBUTION SYSTEM IN OUR CAMPUS.

The following methods are the water distribution systems used in our college campus to distribute the water effectively.

Principal

JKK Munirajah Institute of Health Sciences
College of Pharmacy, T.N.Palayam,
Gobi (Tk), Erode (Dt) - 638 506



JKK MUNIRAJAH INSTITUTE OF HEALTH SCIENCES COLLEGE OF PHARMACY

(Approved by Tamil Nadu Govt. & Pharmacy Council of India - New Delhi, Affiliated to The Tamil Nadu Dr. M.G.R Medical University, Chennai)
Thookanaickenpalayam, Gobichettipalayam (TK), Erode (DT) - 638506, Tamil Nadu.

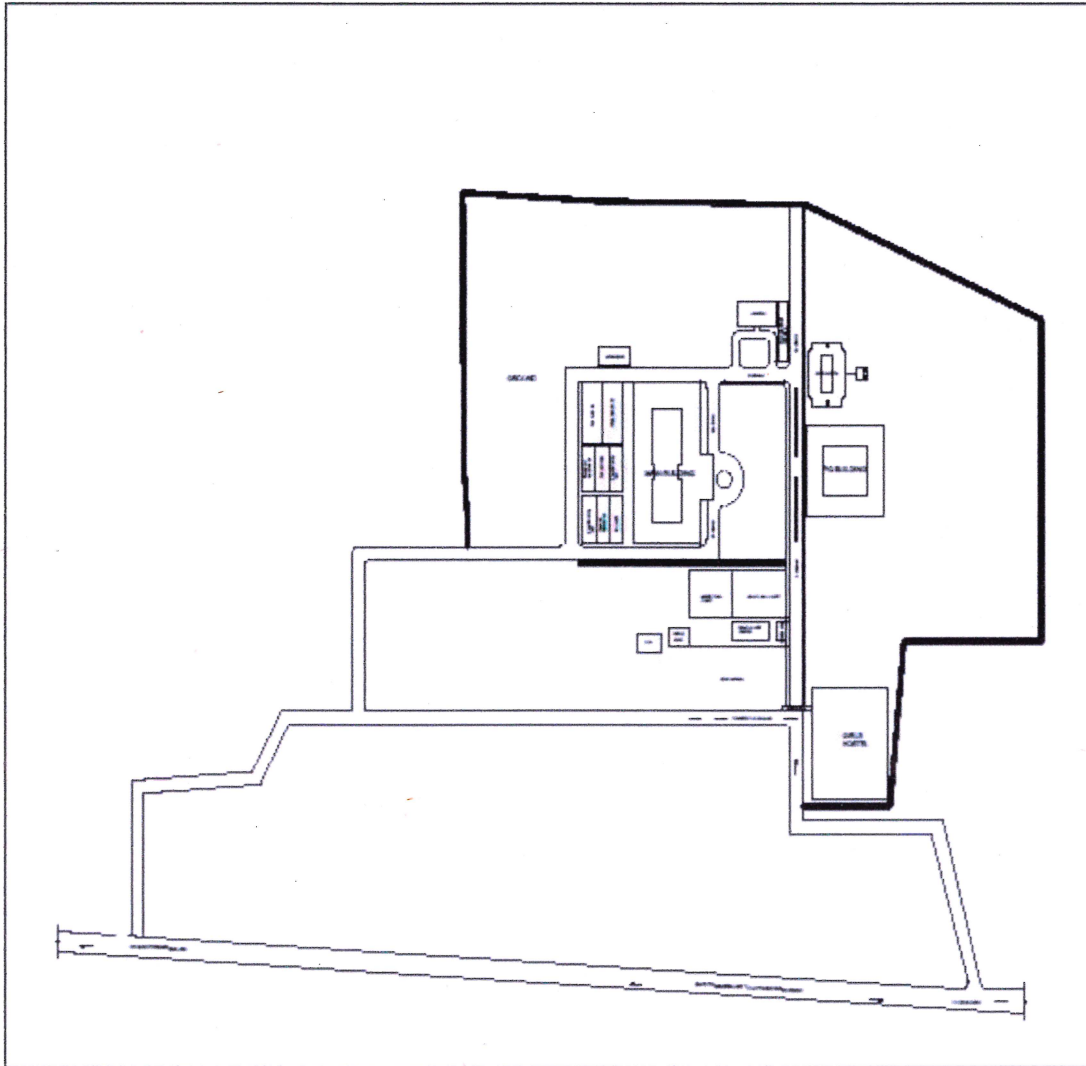

[Handwritten signature]

Principal

JKK Munirajah Institute of Health Sciences
College of Pharmacy, T.N.Palayam,
Gobi (Tk), Erode (Dt) - 638 506



JKK MUNIRAJAH INSTITUTE OF HEALTH SCIENCES COLLEGE OF PHARMACY

(Approved by Tamil Nadu Govt. & Pharmacy Council of India - New Delhi, Affiliated to The Tamil Nadu Dr. M.G.R Medical University, Chennai)
Thookanaickenpalayam, Gobichettipalayam (TK), Erode (DT) - 638506, Tamil Nadu.

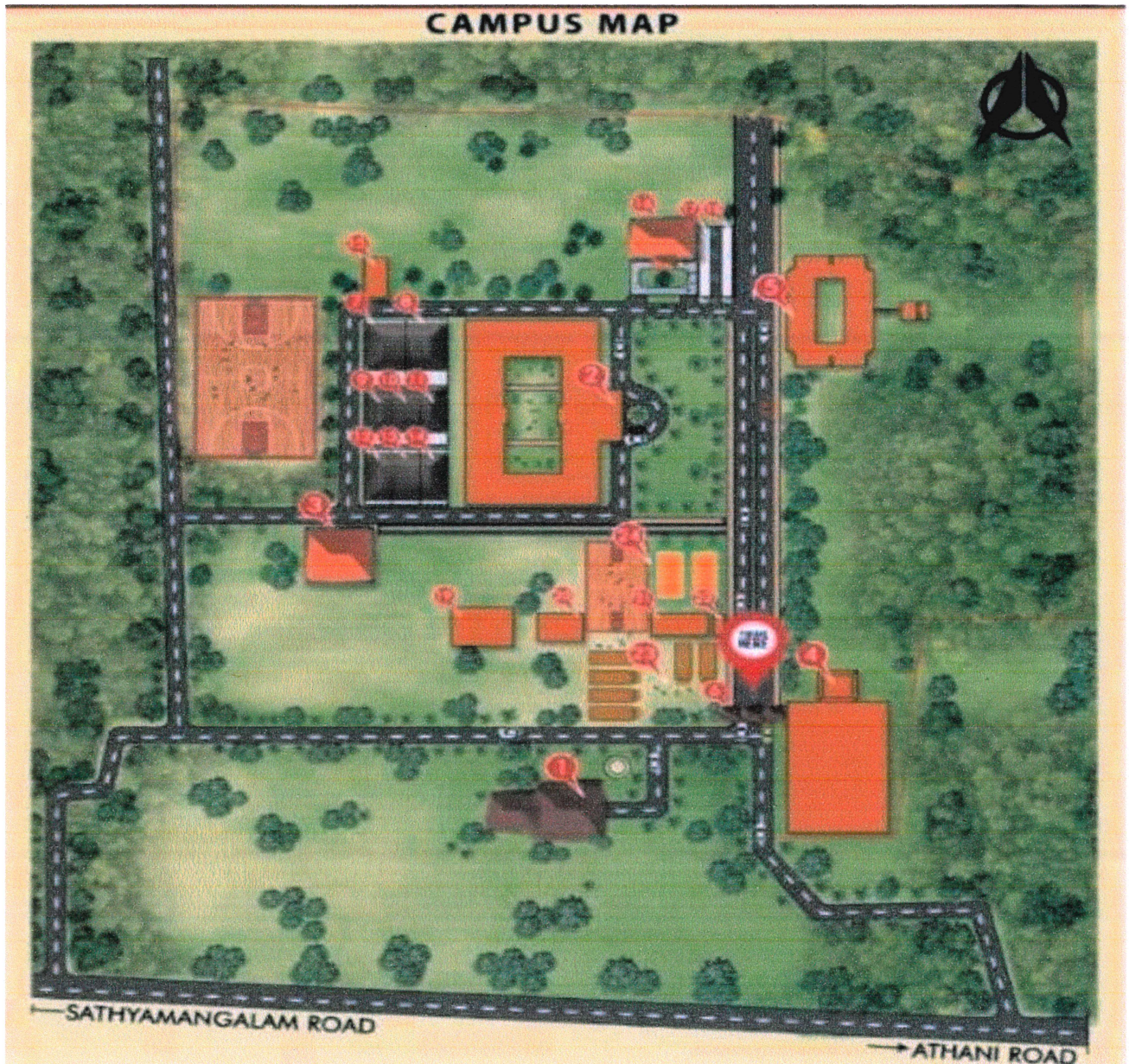

Handwritten signature in green ink.

Principal

JKK Munirajah Institute of Health Sciences
College of Pharmacy, T.N.Palayam,
Gobi (Tk), Erode (Dt) - 638 506



JKK MUNIRAJAH INSTITUTE OF HEALTH SCIENCES COLLEGE OF PHARMACY

(Approved by Tamil Nadu Govt. & Pharmacy Council of India - New Delhi, Affiliated to The Tamil Nadu Dr. M.G.R Medical University, Chennai)
Thookanaickenpalayam, Gobichettipalayam (TK), Erode (DT) - 638506, Tamil Nadu.



PHOTOS OF INSIDE VIEW RAIN WATER HARVESTING STRUCTURE

Principal

JKK Munirajah Institute of Health Sciences
College of Pharmacy, T.N. Palayam,
Gobi (Tk), Erode (Dt) - 638 506



JKK MUNIRAJAH INSTITUTE OF HEALTH SCIENCES COLLEGE OF PHARMACY

(Approved by Tamil Nadu Govt. & Pharmacy Council of India - New Delhi, Affiliated to The Tamil Nadu Dr. M.G.R Medical University, Chennai)
Thookanaickenpalayam, Gobichettipalayam (TK), Erode (DT) - 638506, Tamil Nadu.



PHOTOS OF TANKS AND BUNDS

Principal
JKK Munirajah Institute of Health Sciences
College of Pharmacy, T.N.Palayam,
Gobi (Tk), Erode (Dt) - 638 506



JKK MUNIRAJAH INSTITUTE OF HEALTH SCIENCES COLLEGE OF PHARMACY

(Approved by Tamil Nadu Govt. & Pharmacy Council of India - New Delhi, Affiliated to The Tamil Nadu Dr. M.G.R Medical University, Chennai)
Thookanaickenpalayam, Gobichettipalayam (TK), Erode (DT) - 638506, Tamil Nadu.



PHOTOS OF MAINTENANCE OF DISTRIBUTION SYSTEM

Principal

JKK Munirajah Institute of Health Sciences
College of Pharmacy, T.N. Palayam,
Gobi (Tk), Erode (Dt) - 638 506



JKK MUNIRAJAH INSTITUTE OF HEALTH SCIENCES COLLEGE OF PHARMACY

(Approved by Tamil Nadu Govt. & Pharmacy Council of India - New Delhi, Affiliated to The Tamil Nadu Dr. M.G.R Medical University, Chennai)
Thookanaickenpalayam, Gobichettipalayam (TK), Erode (DT) - 638506, Tamil Nadu.



Handwritten signature in green ink.

Principal
JKK Munirajah Institute of Health Sciences
College of Pharmacy, T.N. Palayam,
Gobi (Tk), Erode (Dt) - 638 506



JKK MUNIRAJAH INSTITUTE OF HEALTH SCIENCES COLLEGE OF PHARMACY

(Approved by Tamil Nadu Govt. & Pharmacy Council of India - New Delhi, Affiliated to The Tamil Nadu Dr. M.G.R Medical University, Chennai)
Thookanaickenpalayam, Gobichettipalayam (TK), Erode (DT) - 638506, Tamil Nadu.



PHOTO OF RO PLANT WATER SYSTEM

Principal
JKK Munirajah Institute of Health Sciences
College of Pharmacy, T.N.Palayam,
Gobi (Tk), Erode (Dt) - 638 506